



SCATTERGOOD & JOHNSON LTD



Certificate number 734/95

ELECTRICAL ENGINEERING AND FLUID CONTROL DISTRIBUTORS

- * Designed for use with low stranded copper conductors
- * Annealed to guarantee optimum ductility and electrolytically tin plated to avoid oxidation.
- * Inspection hole facilitates the full insertion of the copper conductor.

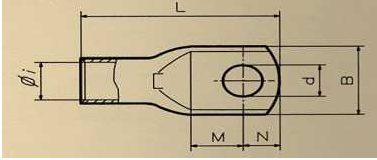

Cembre

Copper Tube Straight Lugs (Tri-rated)



STRAIGHT LUGS (TRI-RATED)

| Conductor Size / mm ² | Stud Size / mm | Lug Dimensions / mm | | | | | | Angle | Pack Qty. | Price / 100 | Part No. |
|----------------------------------|----------------|---------------------|------|------|------|------|----------|----------|-----------|-------------|------------|
| | | Øi | B | M | N | L | d | | | | |
| 10.0 | 5 | 4.6 | 10.0 | 6.5 | 6.0 | 26.0 | 5.3 | Straight | 100 | £23.81 | A2-M5 |
| | 6 | 4.6 | 11.0 | 7.0 | 6.0 | 26.5 | 6.4 | Straight | 100 | £23.81 | A2-M6 |
| | 8 | 4.6 | 15.0 | 9.0 | 8.0 | 30.5 | 8.4 | Straight | 100 | £23.81 | A2-M8 |
| | 10 | 4.6 | 18.0 | 11.0 | 10.0 | 34.5 | 10.5 | Straight | 100 | £27.31 | A2-M10 |
| | 12 | 4.6 | 19.0 | 14.0 | 12.0 | 39.5 | 13.2 | Straight | 100 | £31.91 | A2-M12 |
| 16.0 | 5 | 5.8 | 11.5 | 6.5 | 6.0 | 29.0 | 5.3 | Straight | 100 | £26.66 | A3-M5 |
| | 6 | 5.8 | 11.5 | 7.0 | 6.0 | 29.5 | 6.4 | Straight | 100 | £29.05 | A3-M6 |
| | 8 | 5.8 | 15.0 | 9.0 | 8.0 | 33.5 | 8.4 | Straight | 100 | £29.05 | A3-M8 |
| | 10 | 5.8 | 18.0 | 11.0 | 10.0 | 37.5 | 10.5 | Straight | 100 | £30.81 | A3-M10 |
| | 12 | 5.8 | 20.0 | 14.0 | 12.0 | 42.5 | 13.2 | Straight | 100 | £39.11 | A3-M12 |
| 25.0 | 5 | 7.0 | 14.0 | 6.5 | 6.0 | 31.5 | 5.3 | Straight | 100 | £34.30 | A5-M5 |
| | 6 | 7.0 | 14.0 | 7.0 | 6.0 | 32.0 | 6.4 | Straight | 100 | £34.30 | A5-M6 |
| | 8 | 7.0 | 15.0 | 9.0 | 8.0 | 36.0 | 8.4 | Straight | 100 | £37.13 | A5-M8 |
| | 10 | 7.0 | 18.0 | 11.0 | 10.0 | 40.0 | 10.5 | Straight | 100 | £39.33 | A5-M10 |
| | 12 | 7.0 | 21.0 | 14.0 | 12.0 | 45.0 | 13.2 | Straight | 100 | £44.78 | A5-M12 |
| 35.0 | 6 | 9.3 | 15.0 | 8.0 | 7.0 | 38.5 | 6.4 | Straight | 100 | £62.91 | A9-M6/15 |
| | 8 | 9.3 | 17.0 | 9.0 | 8.0 | 40.5 | 8.4 | Straight | 100 | £62.91 | A9-M8 |
| | 10 | 9.3 | 18.5 | 11.0 | 10.0 | 44.5 | 10.5 | Straight | 100 | £62.78 | A9-M10 |
| | 12 | 9.3 | 21.0 | 14.0 | 12.0 | 49.5 | 13.2 | Straight | 100 | £63.80 | A9-M12 |
| 50.0 | 6 | 11.0 | 15.0 | 8.0 | 7.0 | 40.5 | 6.4 | Straight | 50 | £80.18 | A12-M6/15 |
| | 8 | 11.0 | 19.8 | 9.0 | 8.0 | 42.5 | 8.4 | Straight | 50 | £80.18 | A12-M8 |
| | 8 | 11.0 | 15.0 | 9.0 | 8.0 | 42.9 | 8.4 | Straight | 50 | £80.18 | A12-M8/15 |
| | 10 | 11.0 | 19.0 | 11.0 | 10.0 | 46.5 | 10.5 | Straight | 50 | £80.18 | A12-M10/19 |
| | 12 | 11.0 | 22.0 | 14.0 | 12.0 | 51.5 | 13.2 | Straight | 50 | £82.58 | A12-M12 |
| 70.0 | 6 | 13.0 | 19.0 | 8.0 | 7.0 | 45.0 | 6.4 | Straight | 50 | ##### | A17-M6/19 |
| | 6 | 13.0 | 23.0 | 8.0 | 7.0 | 45.0 | 6.4 | Straight | 50 | ##### | A17-M6 |
| | 8 | 13.0 | 19.0 | 9.0 | 8.0 | 47.3 | 8.4 | Straight | 50 | ##### | A17-M8/19 |
| | 10 | 13.0 | 23.0 | 11.0 | 10.0 | 51.0 | 10.5 | Straight | 50 | ##### | A17-M10 |
| | 10 | 13.0 | 19.0 | 11.0 | 10.0 | 51.0 | 10.5 | Straight | 50 | ##### | A17-M10/19 |
| | 12 | 13.0 | 23.0 | 14.0 | 12.0 | 56.0 | 13.2 | Straight | 50 | ##### | A17-M12 |
| | 14 | 13.0 | 25.0 | 15.5 | 12.0 | 57.5 | 15.0 | Straight | 50 | ##### | A17-M14 |
| 16 | 13.0 | 27.0 | 16.5 | 13.5 | 60.0 | 17.0 | Straight | 50 | ##### | A17-M16 | |
| 95.0 | 8 | 15.0 | 27.0 | 9.0 | 8.0 | 50.0 | 8.4 | Straight | 25 | ##### | A20-M8 |
| | 10 | 15.0 | 27.0 | 11.0 | 10.0 | 54.0 | 10.5 | Straight | 25 | ##### | A20-M10 |
| | 12 | 15.0 | 27.0 | 14.0 | 12.0 | 59.0 | 13.2 | Straight | 25 | ##### | A20-M12 |
| | 14 | 15.0 | 27.0 | 15.5 | 12.0 | 60.5 | 15.0 | Straight | 25 | ##### | A20-M14 |
| | 16 | 15.0 | 27.0 | 16.5 | 13.5 | 63.0 | 17.0 | Straight | 25 | ##### | A20-M16 |
| 120.0 | 8 | 16.5 | 30.0 | 9.0 | 8.0 | 53.5 | 8.4 | Straight | 25 | ##### | A29-M8 |
| | 10 | 16.5 | 30.0 | 11.0 | 10.0 | 57.5 | 10.5 | Straight | 25 | ##### | A29-M10 |
| | 12 | 16.5 | 30.0 | 14.0 | 12.0 | 62.5 | 13.2 | Straight | 25 | ##### | A29-M12 |
| | 14 | 16.5 | 30.0 | 15.5 | 12.0 | 64.0 | 15.0 | Straight | 25 | ##### | A29-M14 |
| | 16 | 16.5 | 30.0 | 16.5 | 13.5 | 66.5 | 17.0 | Straight | 25 | ##### | A29-M16 |
| | 20 | 16.5 | 30.0 | 22.0 | 20.0 | 78.5 | 21.0 | Straight | 25 | ##### | A29-M20 |

150.0 & 185.0 mm² Crimping Lugs Available Ex-Stock on Request.

Denotes narrow palm lugs for reduced terminal aperture.

| | | | | | |
|---|--|--|---|--------------------------------------|-------------------------------------|
| Leeds Tel: 0113 243 0203 | Sheffield Tel: 0114 243 1841 | Gateshead Tel: 0191 460 2233 | Manchester Tel: 0161 876 4337 | Glasgow Tel: 0141 892 0166 | Walsall Tel: 01922 403426 |
| email: sales@scatts.co.uk | | | web: www.scatts.co.uk | | |