

Data sheet

Order No.: 1767025

Type: GMSTB 2,5/ 4-ST-7,62

PCB connector, Screw connection with tension sleeve



The figure shows a 10-position version of the product

1 Main features



• No. of pos.	4	• Nominal current	12 A
• Conductor cross section	2.5 mm ²	• Nominal voltage	630 V
• Color	green (6021)	• Connection direction	
• Pitch	7.62 mm	• Type of packaging	packed in cardboard
• Connection method	Screw connection with tension sleeve		

2 Your advantages

- ✓ Well-known connection principle allows worldwide use
- ✓ Low temperature rise, thanks to maximum contact force
- ✓ Larger pitch for increased voltage requirements
- ✓ Allows connection of two conductors



Make sure you always use the latest documentation.

It can be downloaded at: phoenixcontact.net/product/1767025

1767025 GMSTB 2,5/ 4-ST-7,62**3 Table of contents**

1	Main features.....	1
2	Your advantages	1
3	Table of contents	2
4	3D model in PDF can be activated (Acrobat Reader only).....	3
5	General Technical Data	4
6	Material properties.....	4
7	Dimensions.....	6
8	Series drawing.....	7
9	Packaging information	8
10	Application.....	8
11	General tests	9
12	Mechanical tests.....	9
13	Electrical tests	10
14	Current carrying capacity/derating curves	11
15	Environmental and durability tests	13
16	Type approval and special tests	14
17	Classification for connectors.....	14
18	Approvals	14
19	Commercial Data.....	15
20	corresponding headers.....	15
21	Accessories	15
22	Combination tests.....	16

1767025 GMSTB 2,5/ 4-ST-7,62

4 3D model in PDF can be activated (Acrobat Reader only)

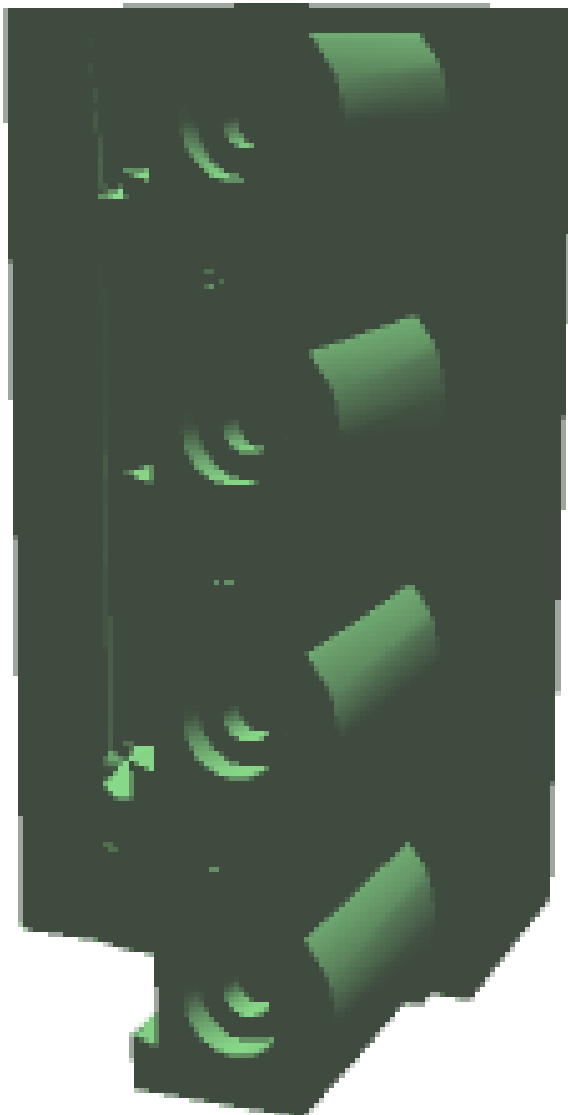

1767025 GMSTB 2,5/ 4-ST-7,62**5 General Technical Data****5.1 item properties**

Order No.	1767025
Type	GMSTB 2,5/ 4-ST-7,62
Plug-in system	CLASSIC COMBICON
Product type	PCB connector
Type of contact	Female connector
Range of articles	GMSTB 2,5/...-ST
Pitch	7.62 mm
Range of positions	2...12
Number of positions	4
Number of levels	1
Number of connections	4
Number of potentials	4
Connection method	Screw connection with tension sleeve
Screw thread	M3
Drive form screw head	Slotted (L)
Type of locking	without
Connection direction of the conductor to the PCB	0 °
Solder pins per potential	1
Type	Standard

5.2 Connection capacity

Conductor cross section, solid	0.2 mm ² ... 2.5 mm ²
Conductor cross section, flexible	0.2 mm ² ... 2.5 mm ²
Conductor cross section flexible, with ferrule without plastic sleeve	0.25 mm ² ... 2.5 mm ²
Conductor cross section flexible, with ferrule with plastic sleeve	0.25 mm ² ... 2.5 mm ²
2 conductors with same cross section, solid	0.2 mm ² ... 1 mm ²
2 conductors with same cross section, stranded	0.2 mm ² ... 1.5 mm ²
2 conductors with same cross section, stranded, with ferrule without plastic sleeve	0.25 mm ² ... 1 mm ²
2 conductors with same cross section, stranded, with TWIN ferrules with plastic sleeve	0.5 mm ² ... 1 mm ²
Cylindrical gauge a x b / diameter	2.8 mm x 2.4 mm / 2.5 mm
Stripping length	7 mm
Tightening torque	0.5 Nm ... 0.6 Nm

5.3 Connection capacity AWG

Conductor cross section AWG	24 ... 12
-----------------------------	-----------

6 Material properties**6.1 Material of metal parts**

1767025 GMSTB 2,5/ 4-ST-7,62

Note	WEEE/RoHS-compliant, whisker-free acc. to IEC 60068-2-82/JEDEC JESD 201
Contact material	Cu alloy
Terminal point surface	Tin (5 - 7 µm Sn)
Surface contact area	Tin (5 - 7 µm Sn)
Surface characteristics	hot-dip tin-plated

6.2 Material Kunststoffteile

	Housing
Color	green (6021)
Insulating material	PA
Insulating material group	I
CTI according to IEC 60112	600
Flammability rating according to UL 94	V0
Glow wire flammability index GWFI according to EN 60695-2-12	850
Glow wire ignition temperature GWIT according to EN 60695-2-13	775
Temperature for the ball pressure test according to EN 60695-10-2	125 °C

1767025 GMSTB 2,5/ 4-ST-7,62**7 Dimensions****7.1 Dimensions for the product**

Length	18.2 mm
Width	28.48 mm
Height	15 mm
Total height	15 mm
Dimension a	22.86 mm

1767025 GMSTB 2,5/ 4-ST-7,62

8 Series drawing

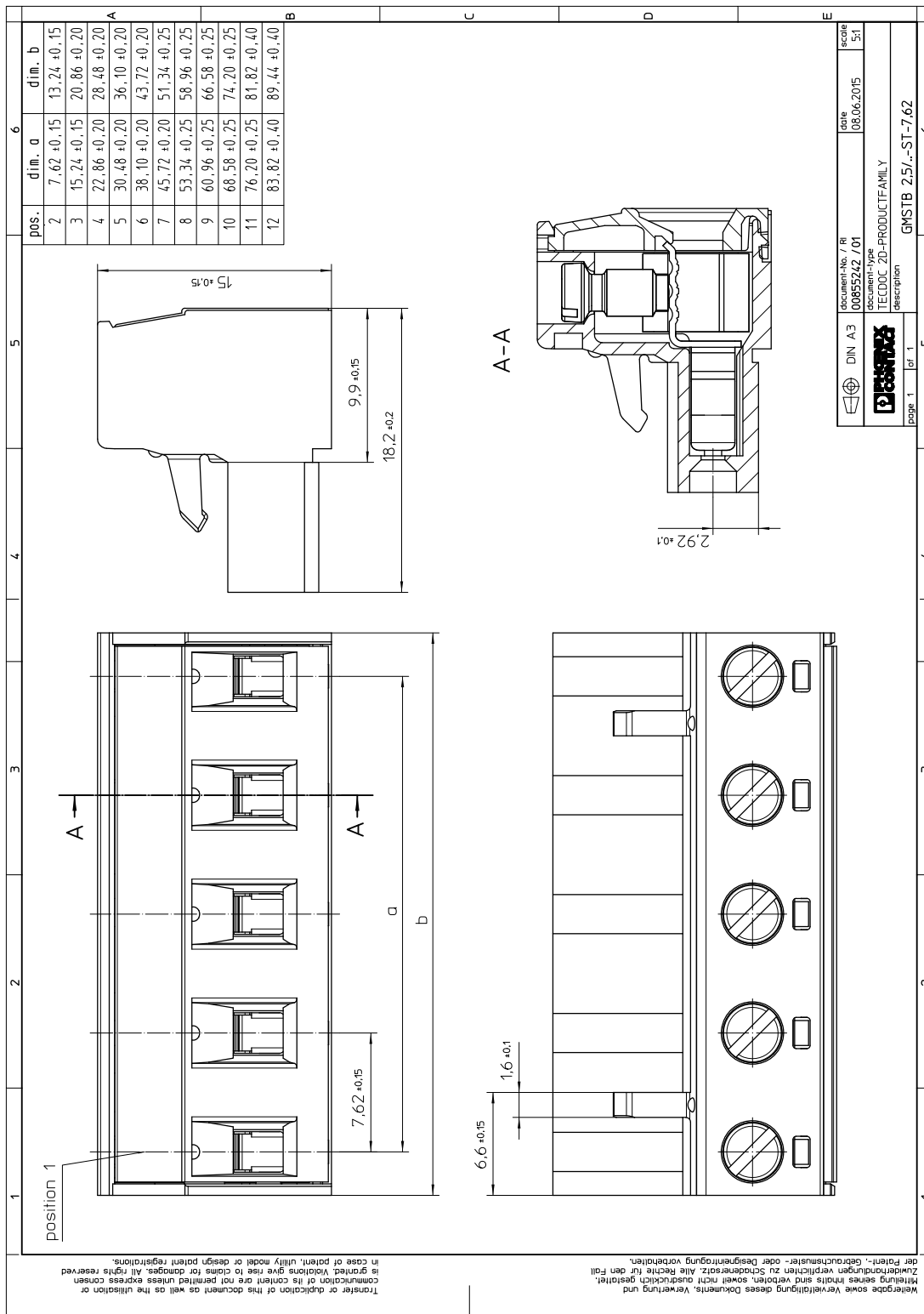

1767025 GMSTB 2,5/ 4-ST-7,62**9 Packaging information**

Type of packaging	packed in cardboard
Pieces per package	50

10 Application**10.1 Temperature limit values**

Ambient temperature (storage/transport)	-40 °C ... 70 °C
Ambient temperature (assembly)	-5 °C ... 100 °C
Ambient temperature (operation)	-40 °C (dependent on the derating curve)

1767025 GMSTB 2,5/ 4-ST-7,62**11 General tests****11.1 Specification**

Specification	IEC 61984
Specification	IEC 60999-1
Brief description	COMBICON connectors

12 Mechanical tests**12.1 Check for damage to conductor or loosening**

Result	Test passed
Specification	IEC 60999-1:1999-11

12.2 Pull-out test

Specification	IEC 60999-1:1999-11
Result	Test passed
Conductor cross section/conductor type/tractive force actual value	0.2 mm ² / solid / > 10 N
Conductor cross section/conductor type/tractive force actual value	0.2 mm ² / flexible / > 10 N
Conductor cross section/conductor type/tractive force actual value	2.5 mm ² / solid / > 50 N
Conductor cross section/conductor type/tractive force actual value	2.5 mm ² / flexible / > 50 N

12.3 Torque test

Specification	IEC 60999-1:1999-11
Result	Test passed

12.4 Mechanical test group A

Specification	IEC 61984:2008-10
Visual examination	Test passed
Specification	IEC 60512-1-1:2002-02
Dimensional test	Test passed
Specification	IEC 60512-1-2:2002-02
Resistance of marking	Test passed
Specification	IEC 60068-2-70:1995-12
Insertion and withdrawal force	Test passed
Specification	IEC 60512-13-2:2006-02
No. of cycles	25
Insertion strength per pos. approx.	8 N
Withdraw strength per pos. approx.	6 N
Polarization and coding	Test passed
Specification	IEC 60512-13-5:2006-02
Test force	20 N
Contact retention in insert	Test passed
Specification	IEC 60512-15-1:2008-05
Test force per pos.	37 N

1767025 GMSTB 2,5/ 4-ST-7,62**13 Electrical tests****13.1 Electrical data**

Rated current / conductor cross section	12 A / 2.5 mm ²
Rated insulation voltage (III/2)	630 V
Rated surge voltage (III/2)	6 kV
Contact resistance	1.3 mΩ
Degree of pollution	2

13.2 Air and creepage distances

Component	PCB connector		
Specification	IEC 60664-1:2007-04		
Mains type	unearthed mains		
Insulating material group	I		
Comparative tracking index (IEC 60112:2003-01)	CTI 600		
Rated insulation voltage	400 V	630 V	1000 V
Rated surge voltage	6 kV	6 kV	6 kV
Degree of pollution	3	2	2
Overvoltage category	III	III	II
Minimum clearance case A (inhomogeneous field)	5.5 mm	5.5 mm	5.5 mm
Minimum value of the creepage path requirement in acc. with table	5 mm	3.2 mm	5 mm

1767025 GMSTB 2,5/ 4-ST-7,62

14 Current carrying capacity/derating curves

Specification	IEC 61984:2008-10
Note	Representation based on IEC 60512-5-2:2002-02
Reduction factor	0.8
Number of positions	See diagram
Conductor cross section	2.5 mm ²

Type: GMSTB 2,5/...-ST-7,62 with GMSTB 2,5/...-G-7,62

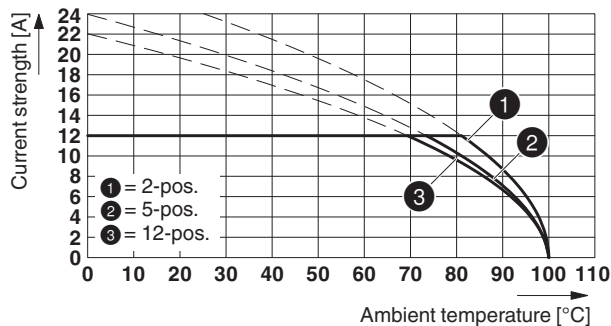

Type: GMSTB 2,5/...-ST-7,62 with GMSTBA 2,5/...-G-7,62

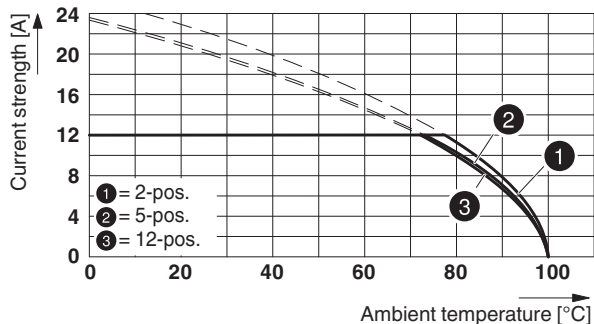

Type: GMSTB 2,5/...-ST-7,62 with GMSTBV 2,5/...-G-7,62

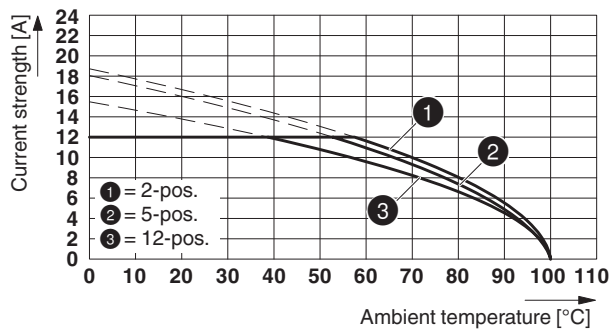

1767025 GMSTB 2,5/ 4-ST-7,62

Type: GMSTB 2,5/..-ST-7,62 with GMSTBVA 2,5/..-G-7,62

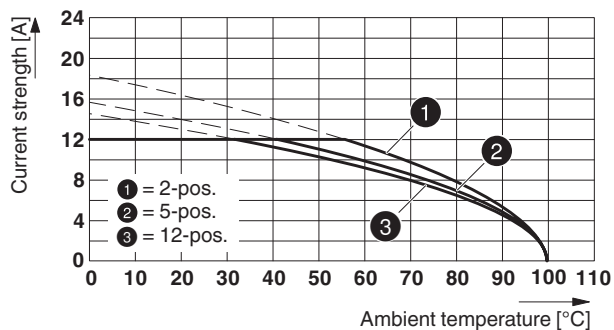

Insulation resistance

Specification IEC 60512-3-1:2002-02

Result Test passed

Insulation resistance, neighboring positions > 20 GΩ

1767025 GMSTB 2,5/ 4-ST-7,62**15 Environmental and durability tests****15.1 Vibration test**

Specification	IEC 60068-2-6:2007-12
Result	Test passed
Frequency	10 - 150 - 10 Hz
Sweep speed	1 octave/min
Amplitude	0.35 mm (10 - 60.1 Hz)
Acceleration	5 g (60.1 - 150 Hz)
Test duration per axis	2.5 h
Test directions	X-, Y- and Z-axis
Note	The connected conductor loops were guided to the test sample at a distance of approx. 10 cm.

1767025 GMSTB 2,5/ 4-ST-7,62**16 Type approval and special tests****16.1 Insulation resistance**

Specification	IEC 60512-3-1:2002-02
Result	Test passed
Insulation resistance, neighboring positions	> 20 GΩ

17 Classification for connectors

Specification	IEC 61984:2008-10
Main features	Connectors without switching capacity (COC)
Construction form	Fixed connectors
Strain relief elements	without strain relief
Connection method	Can be reconnected
Protection against electric shock	Not encapsulated - touch-proof when inserted
Protective conductor	without PE
Lock	no
Connection method	Screw terminal points

18 Approvals

CSA				
Use group	B			
mm ² /AWG/kcmil	28-12			
Voltage	300 V			
Current	10 A			

IECEE CB Scheme				
mm ² /AWG/kcmil	0.2-2.5			
Voltage	400 V			
Current	12 A			

VDE Gutachten mit Fertigungsüberwachung				
mm ² /AWG/kcmil	0.2-2.5			
Voltage	400 V			
Current	12 A			

EAC				
------------	--	--	--	--

cULus Recognized				
Use group	B			
mm ² /AWG/kcmil	30-12			
Voltage	300 V			
Current	15 A			

1767025 GMSTB 2,5/ 4-ST-7,62**19 Commercial Data**

Order No.	1767025
Type	GMSTB 2,5/ 4-ST-7,62
Pieces per package	50
Net weight	7.54 g
GTIN	4017918033033
	Information that applies locally, see link on page 1
Country of origin	Information that applies locally, see link on page 1

20 corresponding headers

Order No.	Type
1766149	GMSTB 2,5/ 4-G-7,62
1766259	GMSTBA 2,5/ 4-G-7,62
1766589	GMSTBV 2,5/ 4-G-7,62
1766796	GMSTBVA 2,5/ 4-G-7,62
1879625	GMSTBA 2,5/ 4-G-7,62 PIN 9,5

21 Accessories

Description	Order No.	Type
Actuation tool, for ST terminal blocks, insulated, also suitable for use as a bladed screwdriver, size: 0.6 x 3.5 x 100 mm, 2-component grip, with non-slip grip	1205053	SZS 0,6X3,5
Coding profile, is inserted into the slot on the plug or inverted header, red insulating material	1734634	CP-MSTB
	0804549	SK 7,62/3,8:FORTL.ZAHLEN
	0805441	SK 7,62/3,8:UNBEDRUCKT
	0805153	SK 7,62/3,8:SO
	1803905	KGG-MSTB 2,5/ 6
Marker pen, for manual labeling of unprinted Zack strips, smear-proof and waterproof, line thickness 0.5 mm	1051993	B-STIFT
	1948048	EB 2-CC 7,5

1767025 GMSTB 2,5/ 4-ST-7,62

22 Combination tests

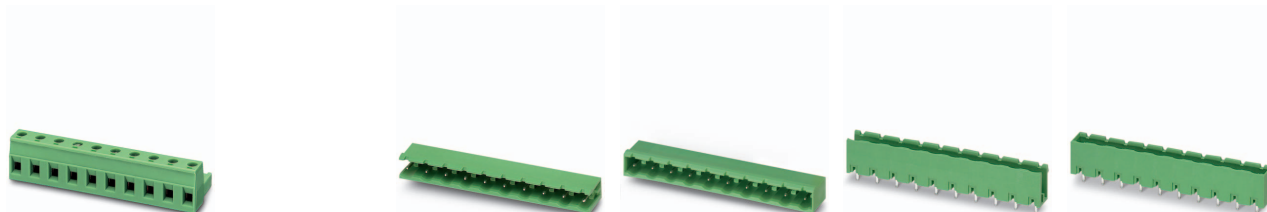

GMSTB 2,5/...-ST

IEC 61984	IEC 61984	IEC 61984	IEC 61984	IEC 61984
Mechanical tests (A)				
Insertion/withdrawal force per position	approx. 8 N / 6 N	approx. 9 N / 6 N	approx. 8 N / 6 N	approx. 7 N / 3 N
Polarization when inserted Requirement >20 N	Test passed	Test passed	Test passed	Test passed
Contact holder in insert Requirements >20 N	Test passed	Test passed	Test passed	Test passed
Durability tests (B)				
Contact resistance R ₁	1.3 mΩ	1.4 mΩ	2.5 mΩ	2.6 mΩ
Insertion/withdrawal cycles	25	25	25	25
Contact resistance R ₂	1.3 mΩ	1.5 mΩ	2.6 mΩ	2.7 mΩ
Rated impulse voltage at sea level Voltage waveform ≥ (1.2/50 μs)	7.3 kV	7.3 kV	7.3 kV	7.3 kV
Power-frequency withstand voltage Voltage waveform ≥ (50/60 Hz)	3.31 kV	3.31 kV	3.31 kV	3.31 kV
Thermal tests (C)				
Tested number of positions	12	12	12	12
Tested conductor cross section	2.5 mm ²	2.5 mm ²	2.5 mm ²	2.5 mm ²
Test current	12 A	12 A DC		12 A DC
Upper limiting temperature Requirements < 100°C	Test passed	Test passed	Test passed	Test passed
Climatic tests (D)				
Test sequence 1: low temperature storage	-40 °C/2 h	-40 °C/2 h	-40 °C/2 h	-40 °C/2 h
Test sequence 2: heat storage	100 °C/168 h	100 °C/168 h	100 °C/168 h	100 °C/168 h
Test sequence 3: noxious gas storage (ISO 6988)	0.2 dm ³ SO ₂ on 300 dm ³ / 40 °C/1 cycle	0.2 dm ³ SO ₂ on 300 dm ³ / 40 °C/1 cycle	0.2 dm ³ SO ₂ on 300 dm ³ / 40 °C/1 cycle	0.2 dm ³ SO ₂ on 300 dm ³ / 40 °C/1 cycle
Rated impulse voltage at sea level Voltage waveform ≥ (1.2/50 μs)	7.3 kV	7.3 kV	7.3 kV	7.3 kV
Power-frequency withstand voltage Voltage waveform ≥ (50/60 Hz)	3.31 kV	3.31 kV	3.31 kV	3.31 kV
Environmental and endurance tests (E)				
Specification	IEC 61984:2008-10	IEC 61984:2008-10	IEC 61984:2008-10	IEC 61984:2008-10
Degree of protection	Finger safety with IP20 test finger	Finger safety with IP20 test finger	Finger safety with IP20 test finger	Finger safety with IP20 test finger



SCATTERGOOD & JOHNSON LTD

ELECTRICAL ENGINEERING & FLUID CONTROL DISTRIBUTORS

Est.1899

At Scattergood & Johnson Ltd, we pride ourselves on being a technical distributor to specialist industries.

Working with a range of quality product suppliers across a number of specialist markets, we are not your average 'box shifter' - we are your technical and supply chain partner.

We fully support every product we sell - for free! Our internal team and external sales engineers can answer any product or application question, no matter the complexity.

Backing up this technical ability is a range of 50,000+ products available from stock for nationwide next day delivery (same day if required!), or you can collect what you need from any of our trade counters around the UK.

Select your specialist interest below to learn more about how we can help.



Online, In Branch and On the Road - Scattergood & Johnson Ltd, there when you need us.

www.scatts.co.uk