

## Mini installation beacon / Flashing Light 208 Flashing Beacon EM 24VDC YE



Part No.: 208.300.55



### MECHANICAL DATA

|                             |                           |
|-----------------------------|---------------------------|
| Height                      | 103 mm                    |
| Diameter                    | 58 mm                     |
| Materials                   | PA-GF<br>PC               |
| Dome colour                 | Yellow                    |
| Housing colour              | Black                     |
| Protection category         | IP65                      |
| Connection                  | Flat plug                 |
| Type of fixing              | Built-in mounting         |
| Service life optical        | 4 million flashes minimum |
| Working temperature minimum | -20°C                     |
| Working temperature maximum | +50°C                     |
| UL Type Rating              | Type 12                   |
| Weight with packaging       | 95 g                      |
| Product weight              | 73 g                      |

### ELECTRICAL DATA

|                             |                                |
|-----------------------------|--------------------------------|
| Operating voltage           | 24V                            |
| Operating voltage type      | DC                             |
| Operating voltage tolerance | +/- 10%                        |
| Rated operational voltage   | 24 VDC                         |
| Rated operational current   | 100 mA                         |
| Rated inrush current        | 500 mA                         |
| Protection class            | Protection class 2             |
| Pollution degree            | 3<br>In the connection area: 2 |

### OPTICAL DATA

|                      |         |
|----------------------|---------|
| Light source         | Xenon   |
| Light colour         | Yellow  |
| Optical signal image | Flash   |
| Flash frequency      | 0.75 Hz |
| Flash output         | 1 J     |



For additional installation and mounting information, refer to the appropriate user guide at [www.werma.com](http://www.werma.com). This printed copy is for information only and is subject to alteration.

Mini installation beacon / Flashing Light 208  
**Flashing Beacon EM 24VDC YE**

DRAWING

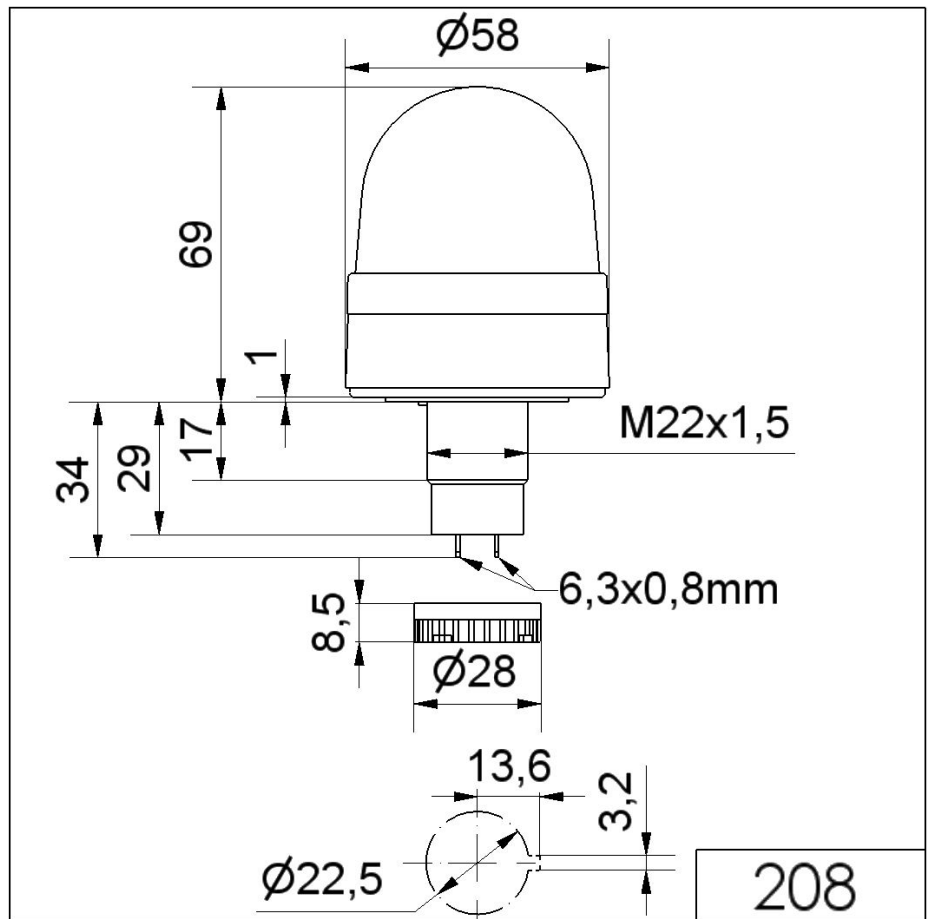

For additional installation and mounting information, refer to the appropriate user guide at [www.werma.com](http://www.werma.com). This printed copy is for information only and is subject to alteration.