



### Model Number

**NMB5-12GM65-E3-V1**

### Features

- 5 mm flush
- Stainless steel sensing face
- Increased operating distance

### Accessories

#### V1-G-2M-PUR

Female cordset, M12, 4-pin, PUR cable

#### V1-W-2M-PUR

Female cordset, M12, 4-pin, PUR cable

#### AB-12

Mounting aid

## Technical Data

### General specifications

|                             |       |   |
|-----------------------------|-------|---|
| Switching function          |       | Normally closed (NC)                    |
| Output type                 |       | PNP                                     |
| Rated operating distance    | $s_n$ | 5 mm                                    |
| Installation                |       | flush (Requirements: see drawing below) |
| Output polarity             |       | DC                                      |
| Assured operating distance  | $s_a$ | 0 ... 4.05 mm                           |
| Actuating element           |       | Ferrous and nonferrous targets          |
| Reduction factor $r_{Al}$   |       | 0.3                                     |
| Reduction factor $r_{Cu}$   |       | 0.2                                     |
| Reduction factor $r_{304}$  |       | 0.85                                    |
| Reduction factor $r_{St37}$ |       | 1                                       |
| Output type                 |       | 3-wire                                  |

### Nominal ratings

|                             |       |                            |
|-----------------------------|-------|----------------------------|
| Operating voltage           | $U_B$ | 10 ... 30 V DC             |
| Switching frequency         | $f$   | 0 ... 360 Hz               |
| Hysteresis                  | $H$   | 3 ... 15 typ. 5 %          |
| Reverse polarity protection |       | reverse polarity protected |
| Short-circuit protection    |       | pulsing                    |
| Voltage drop                | $U_d$ | $\leq 2$ V DC              |
| Operating current           | $I_L$ | $\leq 200$ mA              |
| Off-state current           | $I_r$ | $\leq 10$ $\mu$ A          |
| No-load supply current      | $I_o$ | $\leq 15$ mA               |
| Operating voltage indicator |       | LED, green                 |
| Switching state indicator   |       | LED, yellow                |

### Ambient conditions

|                     |  |                                |
|---------------------|--|--------------------------------|
| Ambient temperature |  | -25 ... 70 °C (-13 ... 158 °F) |
|---------------------|--|--------------------------------|

### Mechanical specifications

|                      |  |  |
|----------------------|--|--|
| Connection type      |  | Connector M12 x 1, 4-pin   |
| Housing material     |  | Stainless steel 1.4305 / AISI 303  |
| Sensing face         |  | Stainless steel 1.4305 / AISI 303  |
| Degree of protection |  | IP67 / IP68 / IP69K - cordset dependent according to cable specification |

### Compliance with standards and directives

|                     |  |   |
|---------------------|--|---|
| Standard conformity |  |   |
| Standards           |  | EN 60947-5-2:2007<br>IEC 60947-5-2:2007 |

### Approvals and certificates

|              |  |  |
|--------------|--|--|
| UL approval  |  | cULus Listed, General Purpose                                      |
| CSA approval |  | cCSAus Listed, General Purpose                                     |
| CCC approval |  | CCC approval / marking not required for products rated $\leq 36$ V |

## Dimensions

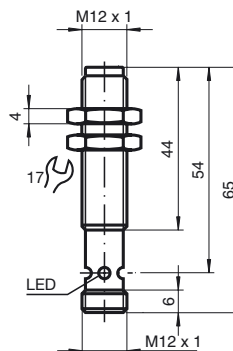

## Electrical Connection

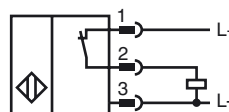

Pinout

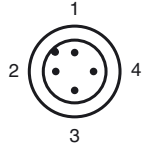

Wire colors in accordance with EN 60947-5-2

|   |    |         |
|---|----|---------|
| 1 | BN | (brown) |
| 2 | WH | (white) |
| 3 | BU | (blue)  |
| 4 | BK | (black) |

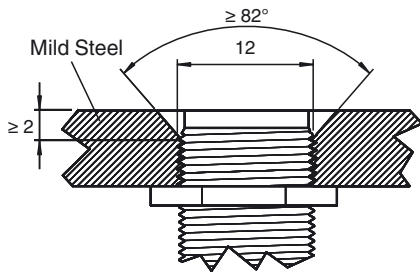

Sensor face is flush with mounting surface.



# SCATTERGOOD & JOHNSON LTD

ELECTRICAL ENGINEERING & FLUID CONTROL DISTRIBUTORS

Est.1899

At Scattergood & Johnson Ltd, we pride ourselves on being a technical distributor to specialist industries.

Working with a range of quality product suppliers across a number of specialist markets, we are not your average 'box shifter' - we are your technical and supply chain partner.

We fully support every product we sell - for free! Our internal team and external sales engineers can answer any product or application question, no matter the complexity.

Backing up this technical ability is a range of 50,000+ products available from stock for nationwide next day delivery (same day if required!), or you can collect what you need from any of our trade counters around the UK.

Select your specialist interest below to learn more about how we can help.



Online, In Branch and On the Road - Scattergood & Johnson Ltd, there when you need us.

# [www.scatts.co.uk](http://www.scatts.co.uk)