



## Model Number

NCB4-12GM40-N0

## Features

- 4 mm flush
- Usable up to SIL 2 acc. to IEC 61508

## Accessories

### BF 12

Mounting flange, 12 mm

## Technical Data

### General specifications

Switching function		Normally closed (NC)
Output type		NAMUR
Rated operating distance	$s_n$	4 mm
Installation		flush
Assured operating distance	$s_a$	0 ... 3.24 mm
Actual operating distance	$s_r$	3.6 ... 4.4 mm typ.
Reduction factor $r_{AI}$		0.41
Reduction factor $r_{CU}$		0.39
Reduction factor $r_{304}$		0.78
Output type		2-wire

### Nominal ratings

Nominal voltage	$U_o$	8.2 V ( $R_i$ approx. 1 k $\Omega$ )
Switching frequency	f	0 ... 1500 Hz
Hysteresis	H	1 ... 15 typ. 5 %
Reverse polarity protection		reverse polarity protected
Short-circuit protection		yes
Suitable for 2:1 technology		yes, Reverse polarity protection diode not required
Current consumption		
Measuring plate not detected		$\geq 2.2$ mA
Measuring plate detected		$\leq 1$ mA
Switching state indicator		all direction LED, yellow

### Functional safety related parameters

MTTF <sub>d</sub>		3010 a
Mission Time ( $T_M$ )		20 a
Diagnostic Coverage (DC)		0 %

### Ambient conditions

Ambient temperature		-25 ... 100 °C (-13 ... 212 °F)
Storage temperature		-40 ... 100 °C (-40 ... 212 °F)

### Mechanical specifications

Connection type		cable PVC, 2 m
Core cross-section		0.34 mm <sup>2</sup>
Housing material		Stainless steel 1.4305 / AISI 303
Sensing face		PBT
Degree of protection		IP66 / IP67
Cable		
Cable diameter		4.8 mm $\pm$ 0.2 mm
Bending radius		> 10 x cable diameter

### General information

Scope of delivery		2 self locking nuts in scope of delivery
Use in the hazardous area		see instruction manuals
Category		1G; 2G; 3G; 1D

### Compliance with standards and directives

Standard conformity		
NAMUR		EN 60947-5-6:2000 IEC 60947-5-6:1999
Electromagnetic compatibility Standards		NE 21:2007 EN 60947-5-2:2007 EN 60947-5-2/A1:2012 IEC 60947-5-2:2007 IEC 60947-5-2 AMD 1:2012

### Approvals and certificates

EAC conformity		TR CU 012/2011
FM approval		
Control drawing		116-0165
UL approval		
Ordinary Location		E87056
Hazardous Location		E501628
Control drawing		116-0452
CSA approval		cCSAus Listed, General Purpose
CCC approval		CCC approval / marking not required for products rated $\leq 36$ V

## Dimensions

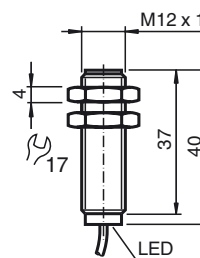

## Electrical Connection

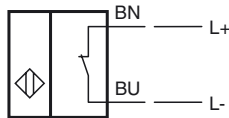

## Equipment protection level Ga

CE marking	CE 0102	
ATEX marking	Ex II 1G Ex ia IIC T6...T1 Ga The Ex-related marking can also be printed on the enclosed label.	
Standards	EN 60079-0:2012+A11:2013 EN 60079-11:2012 Ignition protection "Intrinsic safety" Use is restricted to the following stated conditions	
Appropriate type	NCB4-12GM...-N0...	
Effective internal capacitance	$C_i$	$\leq 120$ nF ; a cable length of 10 m is considered.
Effective internal inductance	$L_i$	$\leq 50$ $\mu$ H ; a cable length of 10 m is considered.
Ambient temperature	Details of the correlation between the type of circuit connected, the maximum permissible ambient temperature, the temperature class, and the effective internal reactance values can be found on the EC-type examination certificate. <b>Note:</b> Use the temperature table for category 1 !!! The 20 % reduction in accordance with EN 1127-1 has already been applied to the temperature table for category 1.	

## Equipment protection level Gb

CE marking	CE 0102	
ATEX marking	Ex II 1G Ex ia IIC T6...T1 Ga The Ex-significant identification is on the enclosed adhesive label	
Standards	EN 60079-0:2012+A11:2013 EN 60079-11:2012 Ignition protection "Intrinsic safety" Use is restricted to the following stated conditions	
Appropriate type	NCB4-12GM...-N0...	
Effective internal capacitance	$C_i$	$\leq 120$ nF ; a cable length of 10 m is considered.
Effective internal inductance	$L_i$	$\leq 50$ $\mu$ H ; a cable length of 10 m is considered.
Maximum permissible ambient temperature $T_{amb}$	Details of the correlation between the type of circuit connected, the maximum permissible ambient temperature, the temperature class, and the effective internal reactance values can be found on the EC-type examination certificate.	

## Equipment protection level Gc (ic)

Certificate	PF 13 CERT 2895 X	
CE marking	CE	
ATEX marking	Ex II 3G Ex ic IIC T6...T1 Gc The Ex-significant identification is on the enclosed adhesive label	
Standards	EN 60079-0:2012+A11:2013 EN 60079-11:2012 Ignition protection category "ic" Use is restricted to the following stated conditions	
Effective internal capacitance	$C_i$	$\leq 120$ nF ; a cable length of 10 m is considered.
Effective internal inductance	$L_i$	$\leq 50$ $\mu$ H ; A cable length of 10 m is considered.

## Special conditions

for $P_i=34$ mW, $I_i=25$ mA, T6	74 °C (165.2 °F)
for $P_i=34$ mW, $I_i=25$ mA, T5	89 °C (192.2 °F)
for $P_i=34$ mW, $I_i=25$ mA, T4-T1	100 °C (212 °F)
for $P_i=64$ mW, $I_i=25$ mA, T6	69 °C (156.2 °F)
for $P_i=64$ mW, $I_i=25$ mA, T5	84 °C (183.2 °F)
for $P_i=64$ mW, $I_i=25$ mA, T4-T1	100 °C (212 °F)
for $P_i=169$ mW, $I_i=52$ mA, T6	51 °C (123.8 °F)
for $P_i=169$ mW, $I_i=52$ mA, T5	66 °C (150.8 °F)
for $P_i=169$ mW, $I_i=52$ mA, T4-T1	74 °C (165.2 °F)
for $P_i=242$ mW, $I_i=76$ mA, T6	39 °C (102.2 °F)
for $P_i=242$ mW, $I_i=76$ mA, T5	52 °C (125.6 °F)
for $P_i=242$ mW, $I_i=76$ mA, T4-T1	52 °C (125.6 °F)

Release date: 2019-12-03 13:26 Date of issue: 2019-12-03 181086\_eng.xml

**Equipment protection level Gc (nL)**

Standard conformity	EN 60079-15:2003 Ignition protection category "n" Use is restricted to the following stated conditions
Effective internal capacitance $C_i$	$\leq 120$ nF ; a cable length of 10 m is considered.
Effective internal inductance $L_i$	$\leq 50$ $\mu$ H ; A cable length of 10 m is considered.
General	The apparatus has to be operated according to the appropriate data in the data sheet and in this instruction manual. The data stated in the data sheet are restricted by this operating instruction! The special conditions must be observed! The ATEX Directive applies only to the use of apparatus under atmospheric conditions. If you use the device outside atmospheric conditions, consider that the permissible safety parameters should be reduced.
<b>Special conditions</b>	
for $P_i=34$ mW, $I_i=25$ mA, T6	74 °C (165.2 °F)
for $P_i=34$ mW, $I_i=25$ mA, T5	89 °C (192.2 °F)
for $P_i=34$ mW, $I_i=25$ mA, T4-T1	100 °C (212 °F)
for $P_i=64$ mW, $I_i=25$ mA, T6	69 °C (156.2 °F)
for $P_i=64$ mW, $I_i=25$ mA, T5	84 °C (183.2 °F)
for $P_i=64$ mW, $I_i=25$ mA, T4-T1	100 °C (212 °F)
for $P_i=169$ mW, $I_i=52$ mA, T6	51 °C (123.8 °F)
for $P_i=169$ mW, $I_i=52$ mA, T5	66 °C (150.8 °F)
for $P_i=169$ mW, $I_i=52$ mA, T4-T1	74 °C (165.2 °F)
for $P_i=242$ mW, $I_i=76$ mA, T6	39 °C (102.2 °F)
for $P_i=242$ mW, $I_i=76$ mA, T5	52 °C (125.6 °F)
for $P_i=242$ mW, $I_i=76$ mA, T4-T1	52 °C (125.6 °F)

**Equipment protection level Da**

CE marking	CE 0102
ATEX marking	Ex II 1D Ex ia IIIC T135°C Da The Ex-related marking can also be printed on the enclosed label.
Standards	EN 60079-0:2012+A11:2013 EN 60079-11:2012 Ignition protection "Intrinsic safety" Use is restricted to the following stated conditions
Appropriate type	NCB4-12GM...-N0...
Effective internal capacitance $C_i$	$\leq 120$ nF A cable length of 10 m is considered.
Effective internal inductance $L_i$	$\leq 50$ $\mu$ H ; a cable length of 10 m is considered.
Maximum permissible ambient temperature $T_{amb}$	Details of the correlation between the type of circuit connected, the maximum permissible ambient temperature, the surface temperature, and the effective internal reactance values can be found on the EC-type-examination certificate. <b>The maximum permissible ambient temperature of the data sheet must be noted, in addition, the lower of the two values must be maintained.</b>

**Equipment protection level Dc**

CE marking	CE 0102
ATEX marking	Ex II 3D IP67 T 111 °C (231.8 °F) X
Standards	EN 50281-1-1 Protection via housing Use is restricted to the following stated conditions
<b>Special conditions</b>	
Maximum heating (Temperature rise)	Values can be obtained from the following list, depending on the max. operating voltage $U_{Bmax}$ and the minimum series resistance $R_v$ .
at $U_{Bmax}=9$ V, $R_v=562$ $\Omega$	11 K
using an amplifier in accordance with EN 60947- 11 K	5-6



# SCATTERGOOD & JOHNSON LTD

ELECTRICAL ENGINEERING & FLUID CONTROL DISTRIBUTORS

Est.1899

At Scattergood & Johnson Ltd, we pride ourselves on being a technical distributor to specialist industries.

Working with a range of quality product suppliers across a number of specialist markets, we are not your average 'box shifter' - we are your technical and supply chain partner.

We fully support every product we sell - for free! Our internal team and external sales engineers can answer any product or application question, no matter the complexity.

Backing up this technical ability is a range of 50,000+ products available from stock for nationwide next day delivery (same day if required!), or you can collect what you need from any of our trade counters around the UK.

Select your specialist interest below to learn more about how we can help.



Online, In Branch and On the Road - Scattergood & Johnson Ltd, there when you need us.

# [www.scatts.co.uk](http://www.scatts.co.uk)