

# INSTRUCTION SHEET

For AS-Interface Safety at Work Slaves  
VAA-\*-F85A-\*

Thank you for purchasing our product. This AS-Interface Safety at Work compatible e-stop is designed for field applications where the e-stop is mounted directly onto a machine. The contents that are not described in this instruction sheet are described in the instruction sheet, "AS-Interface Safety at Work Slave VAA-\*-PM-\*". Please read both sheets carefully. Before installing, wiring, operating of this product or performing maintenance and inspections on this product, please read these instruction sheets carefully. The instruction sheet enables you to use this product correctly. After reading, keep these instruction sheets handy. Please take care to deliver these instruction sheets to the end user. Note that handling this product requires expert knowledge about electricity.

## SAFETY NOTE

This product is manufactured in our tightly controlled production environment. In this instruction sheet, the dangers expected to occur due to improper handling are described where ever you see the "Warning" or "Caution" indicator. These indicators have the following meaning:

### WARNING

Warning notices are used to emphasize that improper operation may cause severe personal injury or death.

### CAUTION

Caution notices are used where negligence might cause personal injury or damage to equipment.

### WARNING

Before using this product, read the instruction sheet for "AS-Interface Safety at Work Slave VAA-\*-PM-\*" carefully. This instruction sheet provides information about installation, setup, operation, and maintenance of this product.

## 1 Type

This data sheet covers two different product variants of the housed style e-stop button:  
e-stop without illumination: VAA-2E-F85A-S-V1  
e-stop with illumination: VAA-2E1A-F85A-S-V1  
Both products have an M12 male connector to interface with the network. The size of push button is  $\phi 40$  mm.

## 2 Specifications

### Environment

Operating temperature	Non-illuminated: -25 to 55°C (no freezing) Illuminated: -25 to 50°C (no freezing)
Storage temperature	-40 to 70°C
Operating humidity	45 to 85% RH (no condensation)

### Structural specifications

Protection grade	IP65
Weight	195g
Connector	M12 sensor connector

## 3 Pin Assign

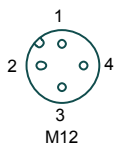

1: AS-i +  
3: AS-i -  
2, 4: not connected

## 4 Dimensions

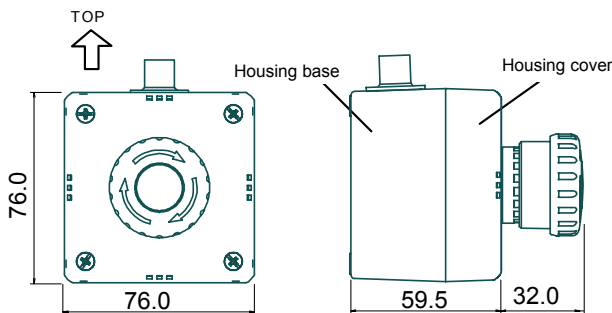

## 5 Mounting Hole Layout

### Installing the e-stop button through the front of the housing

Use two M4 screws or equivalent US size like #6-32 or #6-40 screw.

(Recommended tightening torque: 1.4 to 2.0 Nm)

Determine the screw length by considering the thickness of the e-stop housing and the thickness of the material to which it will be mounted.

\*Mounting screws are not provided with the e-stop

### CAUTION

When installing the product on a panel, the housing cover must be removed from the housing base. Remove all the housing cover mounting screws and remove the housing cover. The housing cover and base are connected by a cable. Do not pull the cable by force when removing the cover.

The cable is connected to the emergency stop switch located on the housing cover side by means of a removable connector. To separate housing base and cover completely, remove the connector. This connector is secured using a locking mechanism designed to prevent inadvertent disconnection. Pull the connector while pressing the locking knob.

4 M4 tapping holes for rear mounting (depth: 10 mm)  
2 front mounting holes

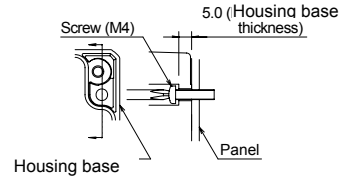
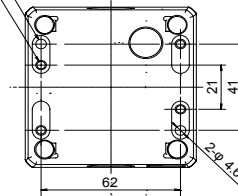

### Installing e-stop housing from the back

When installing from the back, insert M4 tapping screws into holes for the tapping screws on the back of the box base (depth: 8 to 10 mm, tapping screw hole diameter:  $\phi 3.7$  mm). We recommend a tightening torque of 1.3±0.1Nm for M4 screws.

When using other screws, check that the tapping screw hole is not damaged and the screw can be securely tightened.

\*Mounting screws are not provided with e-stop.

### Installing the housing cover and housing base

Attach the housing cover to the base so that the TOP mark on the housing cover and base point in the same direction. Use the housing cover mounting screws to attach the cover to the base.

We recommend a tightening torque of 1.3±0.1Nm.

### CAUTION

Make sure that the housing cover base are attached in the correct orientation. Otherwise, the e-stop housing may be damaged.

## 6 Addressing

Use the handheld addressing device VBP-HH1 which can be directly used to address the e-stop via the integrated M12 connector. For further instructions please see manual of addressing handheld.

## 7 Wiring

Use original P+F accessory for the correct installation to the AS-Interface network. You have different options and you may use e.g. the tap-off splitters  
VAZ-T1-FK-1M-V1-W (rectangular AS-Interface flat cable to M12 connector and 1 meter round cable)  
VAZ-T1-FK-2M-V1-W (rectangular AS-Interface flat cable to M12 connector and 2 meter round cable)  
VAZ-T1-FK-V1 (direct connection to flat cable with M12 connector on top of the splitter)  
Just connect one end with M12 connector to the e-stop and attach the flat cable adapter to the AS-Interface flat cable using the center mounting screw.



# SCATTERGOOD & JOHNSON LTD

ELECTRICAL ENGINEERING & FLUID CONTROL DISTRIBUTORS

Est.1899

At Scattergood & Johnson Ltd, we pride ourselves on being a technical distributor to specialist industries.

Working with a range of quality product suppliers across a number of specialist markets, we are not your average 'box shifter' - we are your technical and supply chain partner.

We fully support every product we sell - for free! Our internal team and external sales engineers can answer any product or application question, no matter the complexity.

Backing up this technical ability is a range of 50,000+ products available from stock for nationwide next day delivery (same day if required!), or you can collect what you need from any of our trade counters around the UK.

Select your specialist interest below to learn more about how we can help.



Online, In Branch and On the Road - Scattergood & Johnson Ltd, there when you need us.

# [www.scatts.co.uk](http://www.scatts.co.uk)