



## ACTUATOR AZ 15/16-B1 CPL.

- Straight actuator
- Particularly suitable for sliding doors

### Data

#### Ordering data

Product type description	ACTUATOR AZ 15/16-B1 CPL.
Article number (order number)	101083036
EAN (European Article Number)	4030661070001
eCl@ss number, version 12.0	27-27-26-06
eCl@ss number, version 11.0	27-27-26-06
eCl@ss number, version 9.0	27-27-26-06
ETIM number, version 7.0	EC001487
ETIM number, version 6.0	EC001487

#### General data

Coding level according to EN ISO 14119	Low
Material of the actuator	Stainless steel (V2A)
Gross weight	18 g

#### Mechanical data

Actuating radius, minimum	160 mm
Actuator	straight rigid

### Pictures

## Product picture (catalogue individual photo)



ID: kaz15f05

| 142.3 kB | .jpg | 352.778 x 234.597 mm - 1000 x 665 px - 72 dpi

| 13.9 kB | .png | 74.083 x 49.389 mm - 210 x 140 px - 72 dpi

| 21.6 kB | .jpg | 123.472 x 82.197 mm - 350 x 233 px - 72 dpi

## Dimensional drawing actuator

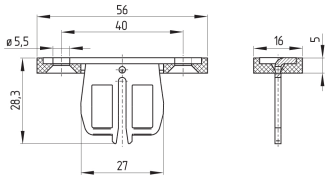

ID: kaz15b05

| 3.3 kB | .png | 74.083 x 39.511 mm - 210 x 112 px - 72 dpi

| 83.4 kB | .jpg | 352.778 x 188.736 mm - 1000 x 535 px - 72 dpi

Schmersal Ltd., Sparrowhawk Close, WR14 1GL Malvern

The details and data referred to have been carefully checked. Images may diverge from original. Further technical data can be found in the manual. Technical amendments and errors possible.

Generated on: 28/05/2024, 14:36