



ACTUATOR AZ 15/16-B3 CPL.

- For very small actuating radii at 90° to the plane of the actuator

Data

Ordering data

Product type description	ACTUATOR AZ 15/16-B3 CPL.
Article number (order number)	101095550
EAN (European Article Number)	4030661104126
eCl@ss number, version 12.0	27-27-26-06
eCl@ss number, version 11.0	27-27-26-06
eCl@ss number, version 9.0	27-27-26-06
ETIM number, version 7.0	EC001487
ETIM number, version 6.0	EC001487

General data

Coding level according to EN ISO 14119	Low
Material of the actuator	Stainless steel (V2A)
Gross weight	17 g

Mechanical data

Actuating radius, minimum	32 mm
Actuator	angled flexible

Note

Note (General)

The axis of the hinge must be 11 mm above and in a parallel plane to the top surface of the safety switch.
Actuating radius adjustable, minimum 32 mm, using an hexagonal key wrench SW 2,5 mm (b)

Pictures

Product picture (catalogue individual photo)



ID: kaz15f23

| 172.5 kB | .jpg | 352.778 x 234.95 mm - 1000 x 666 px - 72 dpi

| 15.9 kB | .png | 74.083 x 49.389 mm - 210 x 140 px - 72 dpi

| 23.4 kB | .jpg | 123.472 x 82.197 mm - 350 x 233 px - 72 dpi

Dimensional drawing actuator

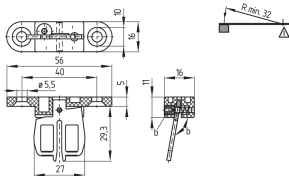

ID: laz15b11

| 51.6 kB | .cdr |

| 10.6 kB | .png | 74.083 x 51.506 mm - 210 x 146 px - 72 dpi

| 112.9 kB | .jpg | 352.778 x 245.886 mm - 1000 x 697 px - 72 dpi

Schmersal Ltd., Sparrowhawk Close, WR14 1GL Malvern

The details and data referred to have been carefully checked. Images may diverge from original. Further technical data can be found in the manual. Technical amendments and errors possible.

Generated on: 28/05/2024, 14:57