

HARTING RJ Industrial® PN
field-installable RJ45 plug
part.-no.: 09 45 151 1121

HARTING Technologiegruppe
Marienwerderstr. 3
D-32339 Espelkamp

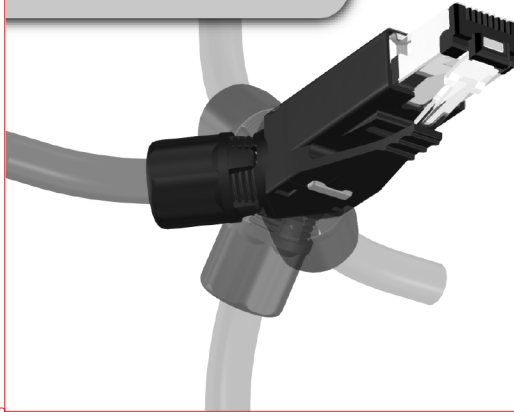

Pushing Performance



09 45 151 1121.99.00
Version 1.0-2011-10

1 pcs.



Made in Romania

HARTING RJ Industrial® PN RJ45 connector
4-pole / 45° angled

- Robust industrial design
- Fully-shielded
- Field-installable with IDC technology
- For solid and stranded conductors
AWG 27 up to AWG 22
- max. wire diameter 1.6 mm Ø
- Cable diameter 4.5 up to 8 mm
- Degree of protection IP 20
- Cat. 5, performance class D
suitable for 10 / 100 Mbit Ethernet
- Temperature range -40 °C up to +70 °C
- 750 mating cycles



HARTING RJ Industrial® 10G RJ45 Steckverbinder
4-polig / 45° gewinkelt

- Stabiles industriegerechtes Design
- Voll geschirmt
- Feldkonfektionierbar mittels IDC-Technologie
- Für Massiv- und Litzenleiter
AWG 27 bis AWG 22
- max. Aderndurchmesser 1,6 mm Ø
- Kabeldurchmesser 4,5 bis zu 8 mm
- Schutzart IP 20
- Kat. 5, Übertragungsklasse D
geeignet für 10 / 100 Mbit Ethernet
- Temperaturbereich -40 °C bis +70 °C
- 750 Steckzyklen

www.HARTING.com

People | Power | Partnership

HARTING RJ Industrial® PN
field-installable RJ45 plug
45° angled

Assembly instruction/
Montageanleitung

1

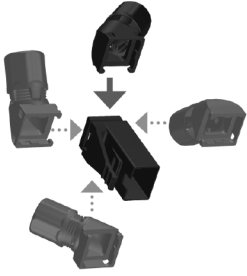

2

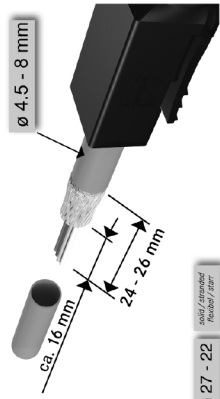

AWG 27 - 22

3

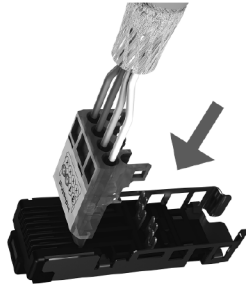

4

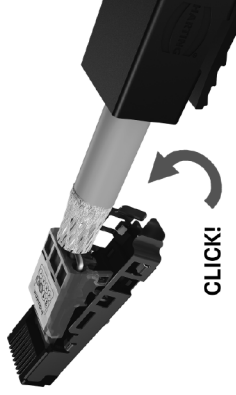

5

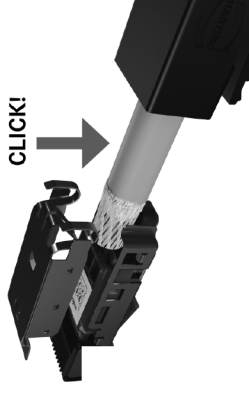

6

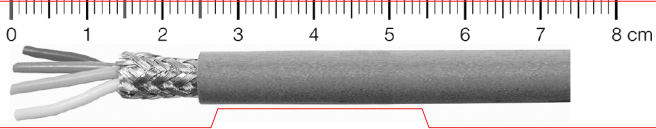
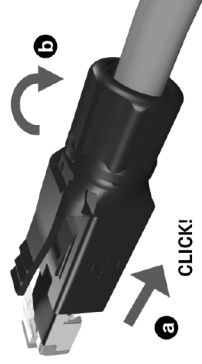

Video assembly instruction/
Video Montageanleitung:
www.HARTING.com/RJIndustrial10G