



## Accessories for ST 98 / Ex 98 ST / Ex 99 ST Straight actuator ST 98/99-B1 Material no.: 1451618

### Product features

- Actuating radius on hinged guards a = 900 mm and b = 700 mm
- Axial misalignment x = 3 mm

### Dimensions

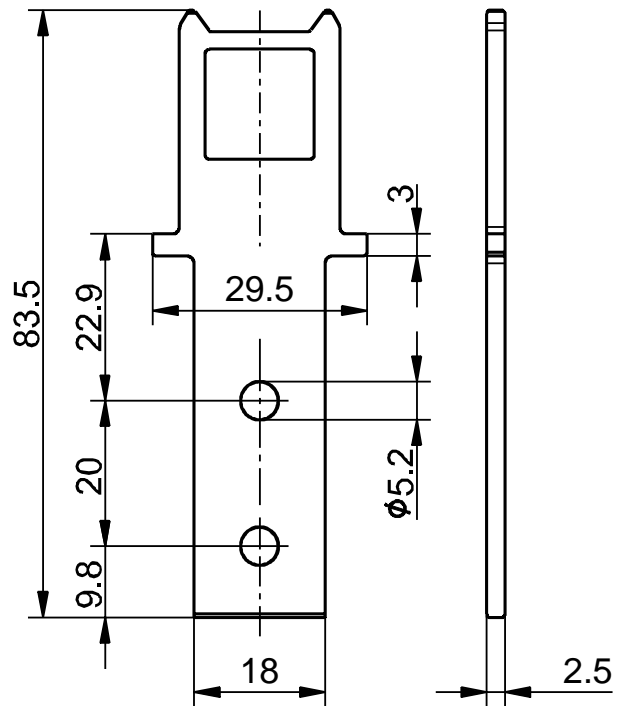



## Accessories for ST 98 / Ex 98 ST / Ex 99 ST Straight actuator ST 98/99-B1 Material no.: 1451618

### Actuating radii

---

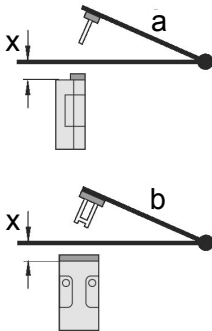

The axis of the hinge should be  $x$  mm above the top edge of the safety switch and in the same plane.

$a$  = Actuating radius to the plane of the actuator

$b$  = Actuating radius in line with the plane of the actuator

$x$  = Axial misalignment

Attention!  $x$  must be referred to the surface of the enclosure and not to the inserted actuator!