

1143

COUNTER-NUT WITH COLLAR, IN PA6.6 POLYAMIDE, METRIC PITCH



Features

TECHNICAL INFORMATION

Range of operating temperature (dynamic)	-20 ÷ 90 °C
Range of operating temperature (static)	-40 ÷ 100 °C
Markings found	thread type
Collar	Yes
Contact cusps	No
Reference standard	CEI EN 60423
Self-extinguishing fire class according to UL 94	V2
Divisible	No

CLASSIFICATION AND DATA ORDERING

Electrocode	36A
ETIM Class 7	Locknut for cable screw gland [EC000940]
Customs code	39269097

MATERIAL COMPOSITION AND TREATMENTS

Material	Polyamide PA6.6
Halogen free	No

CERTIFICATIONS

ROHS compliant	Yes
----------------	-----

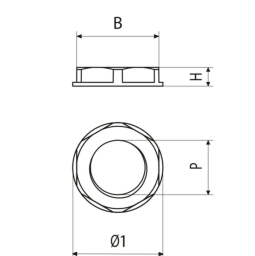

1143

tipo	Suitable for	P	Colour	Width [mm]	Spanner size [mm]	H [mm]	Gross weight [g]	Type of packaging	Unit in minimal packaging [pce]	Unit in standard packaging [pce]
1143M12	1900.M12; 1901.M12; 1910.M12; 1900DP.M12	M12x1.5	Grey RAL 7035	18.5	17	5	0,980	; box	100	100
1143M12N	1900.M12; 1901.M12; 1910.M12; 1900DP.M12	M12x1.5	Black RAL 9005	18.5	17	5	0,953	; box	100	100
1143M12G	1900.M12; 1901.M12; 1910.M12; 1900DP.M12	M12x1.5	Grey RAL 7001	18.5	17	5	0,955	; box	100	100
1143M16	1900.M16; 1901.M16; 1910.M16; 1900DP.M16	M16x1.5	Grey RAL 7035	24	22	5	1,580	; box	100	100
1143M16N	1900.M16; 1901.M16; 1910.M16; 1900DP.M16	M16x1.5	Black RAL 9005	24	22	5	1,540	; box	100	100
1143M16G	1900.M16; 1901.M16; 1910.M16; 1900DP.M16	M16x1.5	Grey RAL 7001	24	22	5	1,540	; box	100	100
1143M20	1900.M20; 1901.M20; 1910.M20; 1900DP.M20	M20x1.5	Grey RAL 7035	29	27	6	2,540	; box	100	100
1143M20N	1900.M20; 1901.M20; 1910.M20; 1900DP.M20	M20x1.5	Black RAL 9005	29	27	6	2,460	; box	100	100
1143M20G	1900.M20; 1901.M20; 1910.M20; 1900DP.M20	M20x1.5	Grey RAL 7001	29	27	6	2,500	; box	100	100
1143M25	1900.M25; 1901.M25; 1910.M25; 1900DP.M25	M25x1.5	Grey RAL 7035	35.5	32	6	3,325	; box	100	100
1143M25N	1900.M25; 1901.M25; 1910.M25; 1900DP.M25	M25x1.5	Black RAL 9005	35.5	32	6	3,320	; box	100	100
1143M25G	1900.M25; 1901.M25; 1910.M25; 1900DP.M25	M25x1.5	Grey RAL 7001	35.5	32	6	3,335	; box	100	100
1143M32	1900.M32; 1901.M32; 1910.M32; 1900DP.M32	M32x1.5	Grey RAL 7035	45	41	7	6,270	; box	50	50
1143M32N	1900.M32; 1901.M32; 1910.M32; 1900DP.M32	M32x1.5	Black RAL 9005	45	41	7		; box	50	50
1143M32G	1900.M32; 1901.M32; 1910.M32; 1900DP.M32	M32x1.5	Grey RAL 7001	45	41	7		; box	50	50
1143M40	1900.M40; 1901.M40; 1910.M40; 1900DP.M40; 1940.M40; 1941.M40	M40x1.5	Grey RAL 7035	55	50	7	10,333	box		
1143M40N	1900.M40; 1901.M40; 1910.M40; 1900DP.M40; 1940.M40; 1941.M40	M40x1.5	Black RAL 9005	55	50	7	10,800	box		
1143M40G	1900.M40; 1901.M40; 1910.M40; 1900DP.M40; 1940.M40; 1941.M40	M40x1.5	Grey RAL 7001	55	50	7	10,533	box		
1143M50	1900.M50; 1901.M50; 1910.M50; 1900DP.M50	M50x1.5	Grey RAL 7035	65	60	8	14,200	box		

tipo	Suitable for	P	Colour	Width [mm]	Spanner size [mm]	H [mm]	Gross weight [g]	Type of packaging	Unit in minimal packaging [pce]	Unit in standard packaging [pce]
1143M50N	1900.M50; 1901.M50; 1910.M50; 1900DP.M50	M50x1.5	Black RAL 9005	65	60	8	14,400	box		
1143M50G	1900.M50; 1901.M50; 1910.M50; 1900DP.M50	M50x1.5	Grey RAL 7001	65	60	8	14,133	box		
1143M63	1900.M63; 1901.M63; 1910.M63; 1900DP.M63	M63x1.5	Grey RAL 7035	82	75	8	22,533	box		
1143M63N	1900.M63; 1901.M63; 1910.M63; 1900DP.M63	M63x1.5	Black RAL 9005	82	75	8	22,267	box		
1143M63G	1900.M63; 1901.M63; 1910.M63; 1900DP.M63	M63x1.5	Grey RAL 7001	82	75	8	22,400	box		



Via Serenissima, 9 - 25135
Brescia - ITALY